

MADHUSAGAR

MODEL COLONY

A WORLD OF LUXURY,
JUST FOR YOU!





Artist's impression



MADHUSAGAR

LUXURIOUS APARTMENTS

LUXURY REDEFINED

Once in a while, comes an opportunity to rise higher and move further ahead in life. And it is truly the mark of success to envision this opportunity and choose an address that matches your ambitions and expectations.

Madhusagar is a luxury residential project at Model Colony. Nestled in one of Pune's prime neighbourhoods, here, every aspect of your home is designed to provide a life of ultimate luxury.

In fact, every home here redefines your lifestyle in every way.

PROJECT HIGHLIGHTS

- Luxurious Apartments
- A modern, attention-grabbing 6-storey elevation
- Exclusive rooftop rejuvenation zone
- Located in the well-connected neighbourhood of Model Colony

PLUSH LIVING ROOMS DESIGNED TO MAKE YOUR EVERY DAY SPECIAL



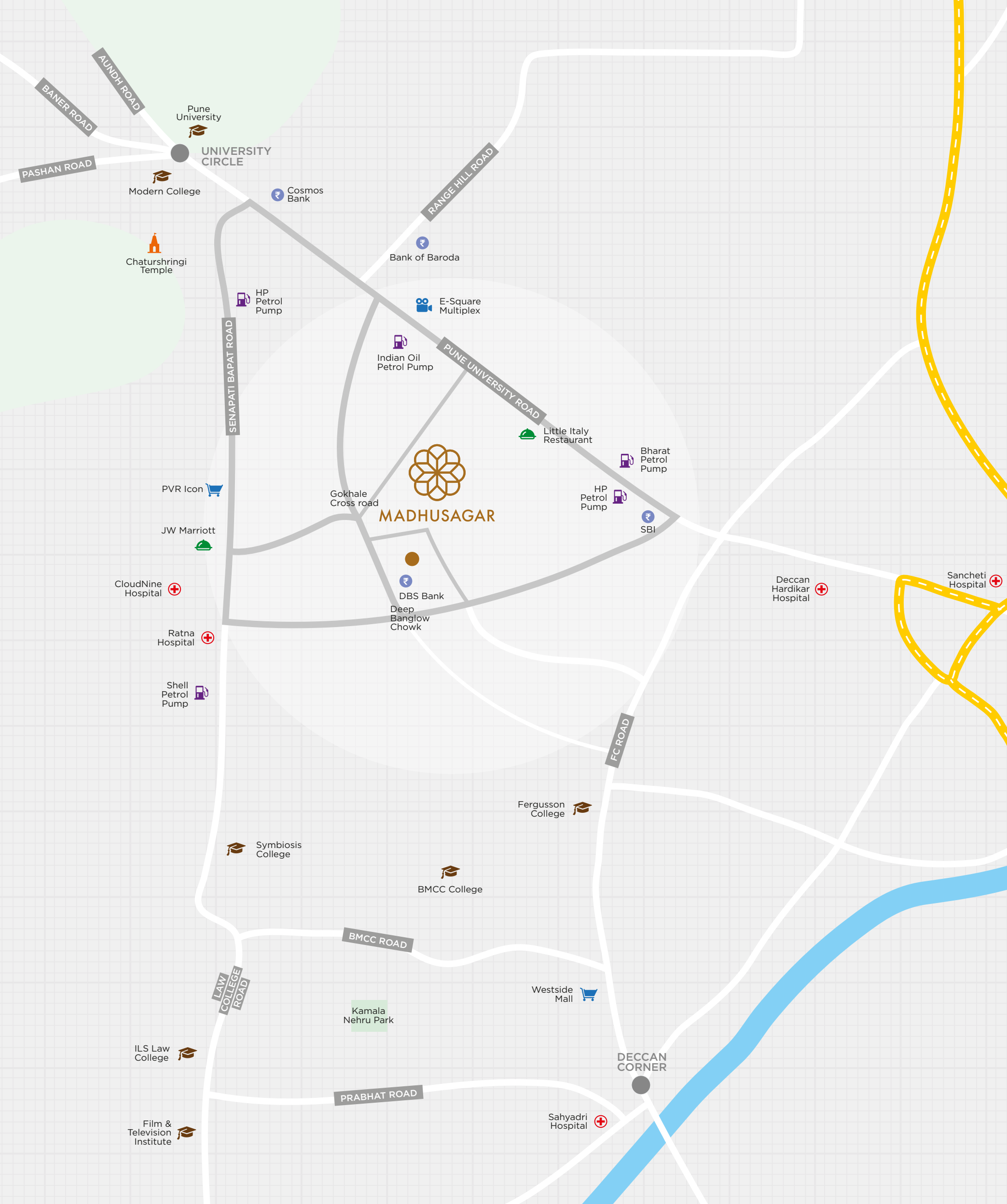

CONNECTIVITY REDEFINED

At Model Colony, Madhusagar is well-connected to everything you need. Nestled in a neighbourhood that is centrally located, this area has all the facilities that one needs.

From easy access to Prabhat Road, Deccan and Kothrud on one side to best connectivity with Aundh, Baner and Pashan on the other side, Madhusagar is close to Pune's best neighbourhoods.

EDUCATION

- Symbiosis College - 900 Mts.
- Symbiosis Nursery - 920 Mts.
- Bharatiya Vidya Bhavan - 1.2 Kms.
- Savitribai Phule Pune University - 1.5 Kms.
- Fergusson College - 2.5 Kms.
- BMCC College - 2.7 Kms.
- Bhandarkar Oriental Research Institute - 2.8 Kms.
- FTII - 3 Kms.

HEALTHCARE

- CloudNine Hospital - 950 Mts.
- MMF Ratna Hospital - 1.8 Kms.
- Sahyadri Hospital - 4.1 Kms.

MALLS & MULTIPLEXES

- Pavillion Mall - 800 Mts.
- PVR Icon - 800 Mts.
- E-Square Multiplex - 1.5 Kms.
- Westside - 3.6 Kms.

BANKS

- Cosmos Bank - 300 Mts.
- DBS Bank - 300 Mts.
- State Bank of India - 750 Mts.
- Bank of Baroda - 850 Mts.
- HDFC Bank - 850 Mts.

PLACES OF WORSHIP

- Shiva Temple - 850 Mts.
- Chaturshringi Temple - 1.6 Kms.
- Dagdusheth Halwai Temple - 3.5 Kms.



SPACE REDEFINED

Indoor luxury is what sets the tone for a redefined living. At Madhusagar, this indoor luxury comes from two exclusive features. One is the the grandeur and second, the power to customise.

The homes at Madhusagar offer best-in-class carpet area, while offering an opportunity to customise the grandeur by combining two apartments into one grand residence.

SPACIOUS BEST-IN-CLASS HOMES

EXQUISITE DINING AREA THAT BRINGS THE FAMILY TOGETHER



EXCLUSIVE
REJUVENATION,
JUST FOR YOU!





MADHUSAGAR

LUXURIOUS APARTMENTS

RELAXATION REDEFINED

We value the joy of spending time with loved ones. In today's fast world, it is important to have a life that is balanced between work and relaxation. At Madhusagar, we have made sure that there is ample opportunity for everyone in your family to relax and rejuvenate.



Outdoor Seating Area
At Top Terrace

ALL THIS IS MADE AVAILABLE THROUGH A ROOFTOP ZONE
THAT OFFERS SOMETHING FOR ALL AGE GROUPS.

STYLISH KITCHENS THAT BRING WARMTH TO YOUR LIFE



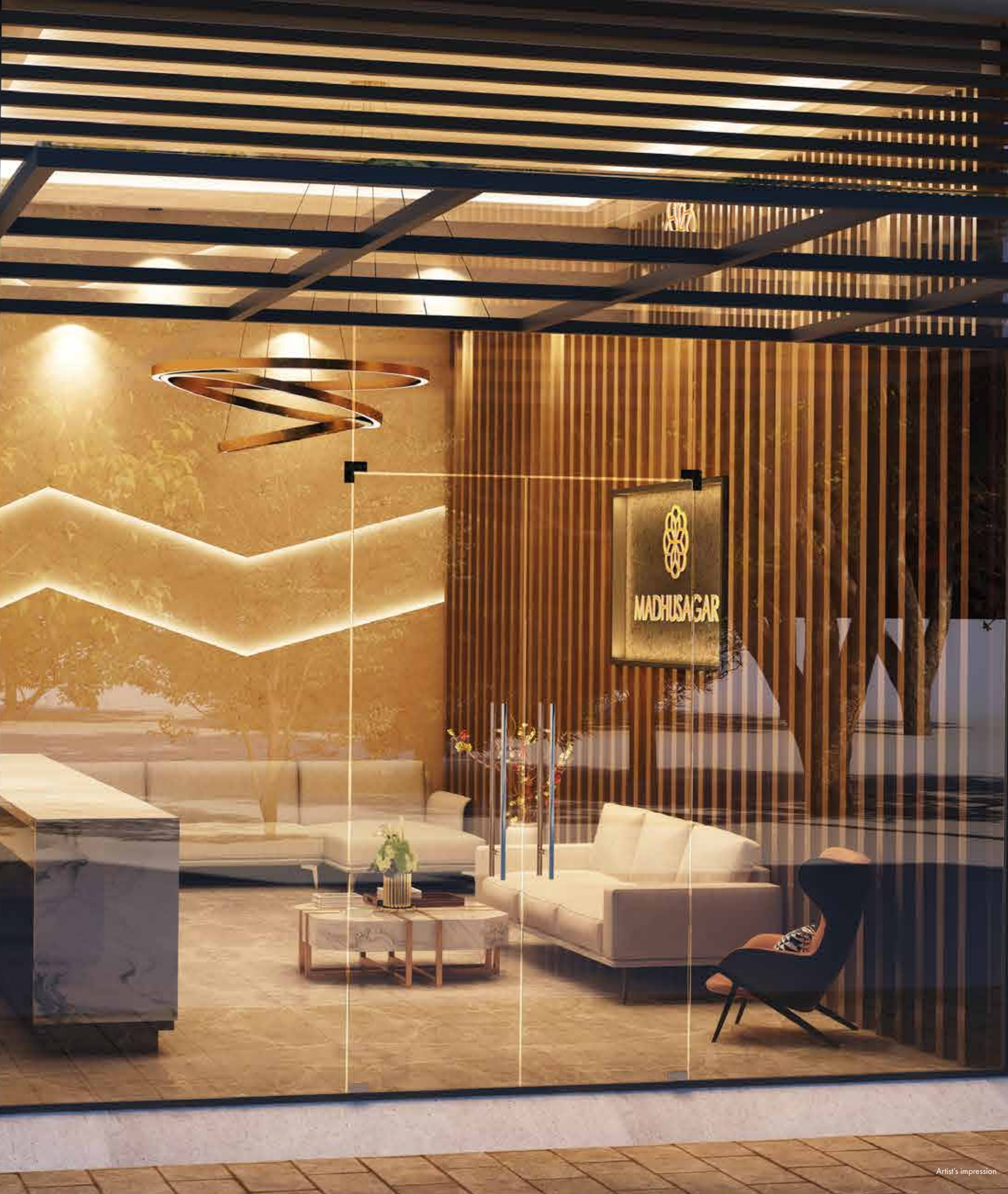

A REFINED EXPERIENCE, JUST FOR YOU!

A home is so much more than a place to live. It is about a wholesome living experience.

Homes at Madhusagar come with the best possible interiors that exude grandeur in every way.

When you step into a home here, you experience a luxurious difference!

DESIGNER ENTRANCE LOBBY WITH WAITING LOUNGE

FALSE CEILING AT MAIN ENTRANCE & LIFT LOBBY

ARCHITECTURALLY DESIGNED FACADE

MECHANISED PARKING

SECURED ACCESS AT LOBBY

CCTV FOR COMMON AREAS & LIFTS



TAILOR-MADE FOR LUXURY

Every home at Madhusagar is designed to exude the best of luxury life for a vibrant and happy lifestyle.

STRUCTURE

- Earthquake-resistant RCC frame structure.

MASONRY

- ACC block / fly ash brick walls.

WALL FINISH & PAINTING

- External walls - Sand faced plaster finished with external grade acrylic emulsion paint.
- Internal walls - Gypsum plaster finished with oil bond distemper paint.
- Internal ceiling finish - Oil bond distemper paint.

FLOORING

- Driveway & parking - Trimix/paver block
- Vitrified tiles of 800 mm X 800 mm for living, dining, kitchen & bedroom.
- Kitchen dado tiles - 300 mm x 600 mm, 600 mm X 600 mm; Up to 600 mm above platform up to 600 mm height from platform top.
- Toilet dado tiles 300 mm x 300 mm, 600 mm X 600 mm. Height up to lintel level.
- Toilet floor - Anti-skid tiles of 300 mm x 600 mm or 600 mm x 600 mm for bathrooms.
- Terrace floor - Anti-skid tiles of 400 mm X 400 mm or 600 mm X 600 mm or 450 mm X 450 mm.
- Lift lobby - Vitrified tile 600 mm X 600 mm or 800 mm X 800 mm or 600 mm x 1200 mm.

KITCHEN

- Counter - Granite counter with fascia and skirting behind.
- Window jam treatment - Granite on the sill.
- Stainless steel sink-single bowl
- Water provision with sink mixer - Domestic and drinking water; separate provision of water purifier

- Electrical supply for refrigerator, oven & exhaust fan, chimney & washing machine.

UTILITY / DRY BALCONY

- Electrical supply for washing machine
- Parapet wall with MS railing
- Dado tiles up to 1050 mm height from floor finish level

BATHROOM & TOILET

- Dado tiles - 300 mm x 600 mm or 600 mm x 600 mm up to lintel level.
- Concealed plumbing for water supply with CP & sanitary fittings.
- Provision for exhaust fan in all bathrooms.
- Ventilator jam treatment - Granite on all sides of the ventilator.
- Solar water connection to master bedroom washroom.
- Electrical supply for geyser.



Artist's impression

COMFORT REDEFINED

Every home at Madhusagar comes with the best specifications and fittings to give you the most comfortable living experience.

DOOR / WINDOWS

- Main entrance door with nameplate & door fittings
- Internal doors - Flush door with a laminate finish
- Terrace door & windows - Three - track powder - coated aluminium sliding door with mosquito mesh & glass railing
- Window jam treatment - Granite on the sill

ELECTRICAL

- Concealed wiring & cabling
- Wi-Fi provision
- Modular switch boards
- Robust distribution board
- Telephone/ intercom facility in master bed & living room
- Dedicated electrical supply for air conditioning units in each bedroom & in the living hall
- Earth leakage circuit breaker

COMMON AREA SPECIFICATIONS

- Directory board and letterbox
- Elegant entrance lobby with waiting lounge
- False ceiling at main entrance & lift lobby
- Electrical backup for lifts and common areas
- Covered two-wheeler and four - wheeler parking
- Fire hydrant system as per PMC norms
- Access controlled doors at the main entrance lobby
- CCTV for common areas & lifts
- LED street lights
- Provision for electrical vehicle (EV) charging points

COMMON AREA FACILITIES

- Domestic drinking water, drainage and storm water drainage line
- Underground water tank and overhead water tanks as per PMC norms
- Rainwater harvesting system
- Space for placing air conditioner outdoor units
- Architecturally designed facade
- Space for senior citizen seating at the rooftop terrace
- Space for children's play area at the rooftop terrace

ROADSIDE



FLOOR PLAN
TYPICAL 4TH TO 6TH FLOOR



FLAT NO.	RERA CARPET AREA	OPEN + DRY BALCONY	TOTAL CARPET AREA	TOTAL CARPET AREA	FLOWER BED AREA
	SQ.M.	SQ.M.	SQ.M.	SQ.FT.	SQ.FT.
401/501/601	77.03	7.52	84.55	910	14.00
402/502/602	77.03	7.52	84.55	910	14.00
403/503/603	77.03	7.52	84.55	910	14.00
404/504/604	77.03	7.52	84.55	910	14.00



A PROJECT BY

siddhashila



IN
ASSOCIATION
WITH

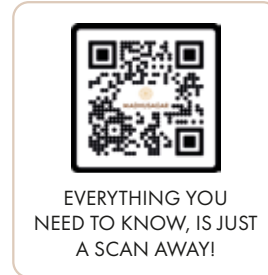

EVERYTHING YOU
NEED TO KNOW, IS JUST
A SCAN AWAY!

SITE ADDRESS

Madhusagar Co. Op Hsg. Soc. Ltd, CTS No. 1038, Final Plot No. 363/8,
Model Colony, Near Cosmos Bank, Shivaji Nagar (Bhamburda), Pune 411016.

www.madhusagar.co

REGISTERED OFFICE ADDRESS:

Siddhashila Ventures LLP, 770/4, Siddhashila House, Lane No. 7,
Bhandarkar Road, Deccan Gymkhana, Pune - 411004 T: +91 020 2567 9292 | sales@madhusagar.co

CONTACT: +91 84118 82828, +91 84118 83838

 MahaRERA No.: P52100047028 | www.maharera.mahaonline.gov.in

DISCLAIMER : Madhusagar is being developed by Siddhashila Ventures LLP. The project has been registered via MahaRERA registration number P52100047028 and is available on the website <https://maharera.mahaonline.gov.in> under registered projects. Allottee/s are requested to visit the said link to update themselves with all the necessary details of the project, from time to time. Actual product/development and any other aspect, may differ from what is portrayed herein. All layouts, plans, specifications, dimensions, designs, measurements and locations, are indicative and not to scale, and are subject to change as may be required by the competent regulatory authority. The pictures of the proposed Residential Flat, furniture, objects, electronic goods, accessories etc. specified herein, are only for the purpose of showcasing the interior layout of the Residential Flat, and the promoter/developer is not liable to provide the same. Intending allottee/s are bound to inspect and apprise themselves with all plans, approvals and other relevant information prior to booking and/or purchase decisions. Nothing in this brochure is intended to substitute the actual plans and approvals obtained from time to time. Maps are not to scale. The common layout will be developed and delivered as per the timelines disclosed on the MahaRERA website, provided timely approvals are received for the same from the appropriate approving authorities. The relationship between the promoter/ developer and the actual allottee/s will be governed strictly by the agreements to be executed from time to time and not on the terms of this brochure. This brochure is merely conceptual and the promoter/developer reserves the right to change, amend and modify the contents from time to time. It cannot be treated as part of the booking and/or final purchase agreement/s that may be executed from time to time. The brochure and its contents shall not be construed as any offer / promise/commitment of any nature in respect of the project.